

CMS Operator Guide

This visual presentation is intended to help the user understand the Draeger Chip Measurement System

It is not intended to substitute for any specific instructions

IT IS THE USER'S RESPONSIBILITY TO READ AND UNDERSTAND ALL MANUALS AND INFORMATION PROVIDED WITH THE CMS!



Intended Use

- **The Draeger CMS is a hand held on-the-spot detection tool for the measurement of toxic gases and vapors in the workplace. It can be used for exposure measurements, confined space entry, process control, & environmental control.**



The CMS Chip

- Ten individual tests per CMS Chip
- Two year shelf life, stamped on the box
- Store below 77 °F
Do Not Freeze
- Safely contains hazardous glass fragments
- Over 50 chips!

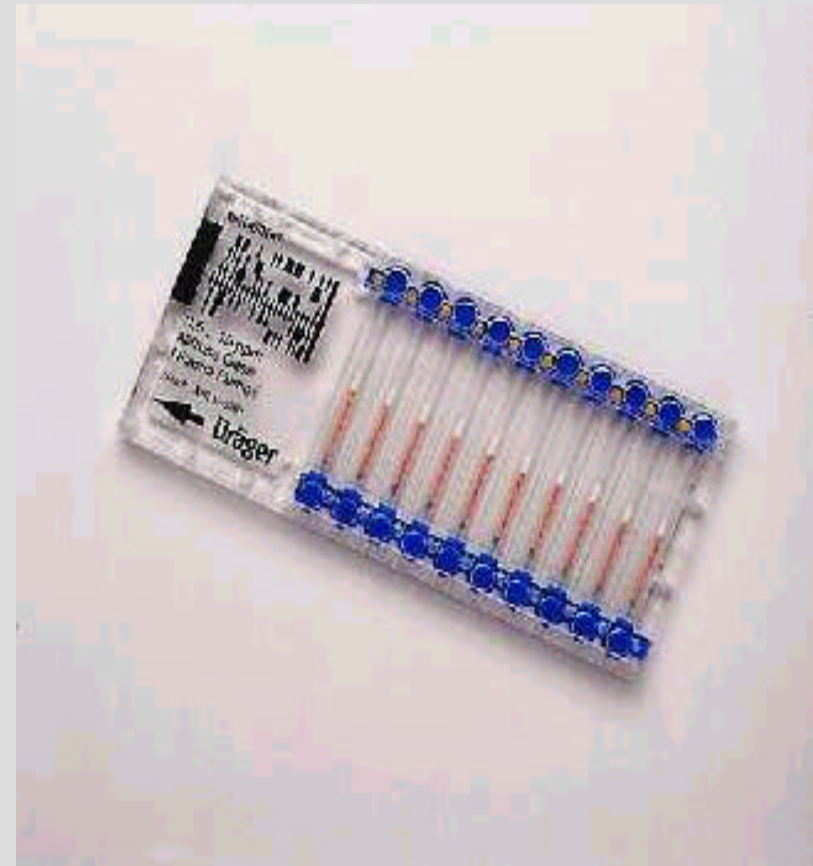

The CMS Analyzer

- Slide Switch
- Digital Display
- Operates on 4 “AA” batteries
- No Calibration
- Minimal Training



Turning On the Analyzer

- Slide switch to position 1:
Analyzer performs a self-test
of electronic functions.

Display elements are activated:

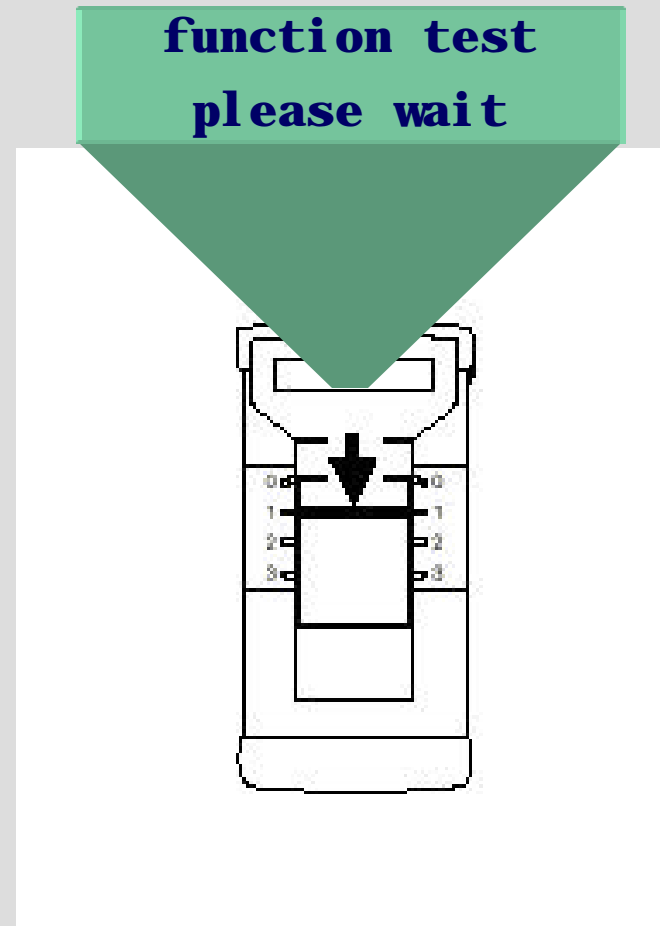

Inserting the Chip

- Make certain the sliding switch is in position 1.
 - **WAIT** for the “load chip” prompt.
- 1 Insert Chip with arrow pointing toward the analyzer and barcode up, into the Chip inlet as shown in the diagram.
Only hold Chip on edges.
 - 2 Press Chip in upward direction in order to open the **blue** chip inlet port.
 - 3 Slide Chip evenly and completely into the Chip inlet.

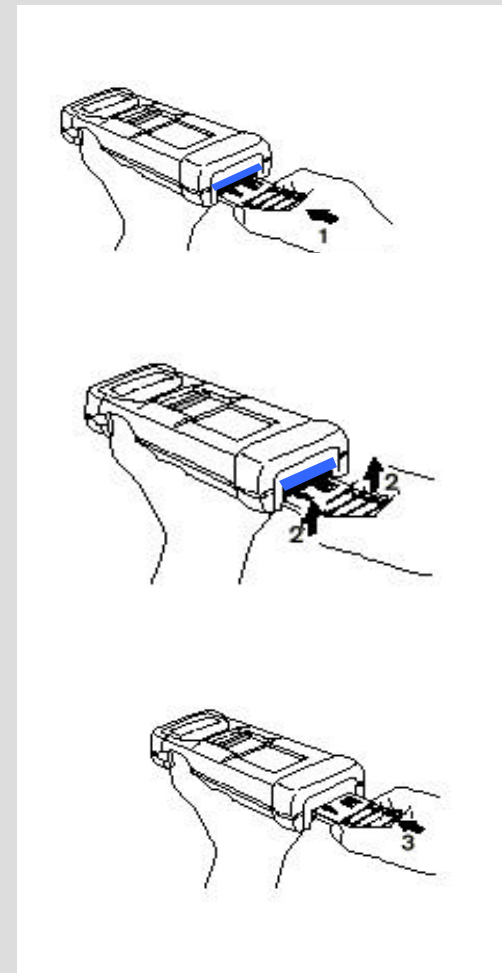

After inserting the Chip

- Slide switch to position 2
Wait for chip OK
- Slide switch to position 3
Measurement is conducted
- The result is displayed at
the end of the
measurement

**Measurements are as simple
as 1-2-3 !**

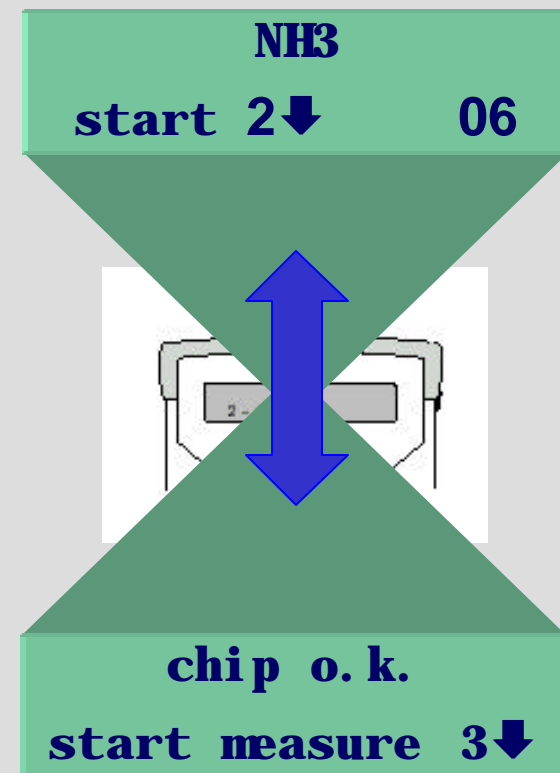

Performing a Measurement

- At the end of the measurement, the result is indicated in combination with a beep.

**analysis
please wait**

Then alternating messages appear in the display:

**NH₃
5.5 ppm**

**next 2↑
5.5 ppm**

To take the next measurement return to position 1 and repeat the process

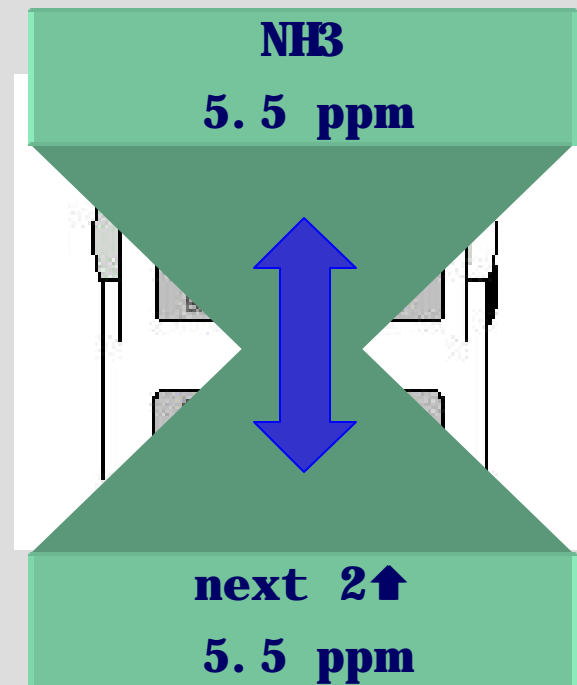

Display Backlighting

Backlight can be switched on in positions 1, 2, or 3.

- Briefly press the side button:
Display illuminated for approx. 5 secs.
- Press side button for 2 secs:
Display will remain illuminated until the device is switched off.



CMS Support

Draeger is happy to assist you with any questions you have on the use of the CMS.

Draeger Safety (USA) toll free
@ 800/922-5518

Draeger Canada toll free
@ 877/372-4371

