

3M™ LeadCheck™ Swabs



**Easy to use.
Instant results.**

It's recognized.

Since April 22, 2010, contractors performing renovation, repair and painting (RRP) projects in pre-1978 homes, schools and daycare facilities are required to be certified and follow lead-safe work practices. This EPA-issued RRP Rule is aimed at preventing lead poisoning.

When used by a certified renovator, 3M™ LeadCheck™ Swabs are EPA-recognized to determine that lead-based paint is not present on wood and metal, making them an important tool when following the RRP Rule.

It's simple.

3M™ LeadCheck™ Swabs are disposable, convenient and simple to use. The entire test typically takes about 30 seconds. Just swab virtually any surface or material, including painted wood or metal. If the swab turns red, lead is present: **RED MEANS LEAD.™**

- EPA recognized*
- Instant results using only a no-mess swab
- Easy, clean and contained
- Detects lead down to 600 ppm



3M™ LeadCheck™ Swabs are available in retailer and contractor packs. See last page for ordering info.



3M™ LeadCheck™ Swabs help certified renovators meet the requirements of the RRP Rule by making lead testing simple.

3M
LeadCheck™
Swabs

*When used by a certified renovator to determine that lead-based paint is not present on wood and metal.

3M is leading the way in helping to prevent lead poisoning.

Lead poisoning can cause severe health effects, including damage to the liver, kidneys, brain, nerves, bones and blood. Children are especially at high risk. Lead in dust is the most common way people are exposed, especially during renovation or repair work.

3M™ LeadCheck™ Swabs are just one of a trusted portfolio of 3M™ Lead-Safe Work Products that includes respirators, coveralls, gloves, duct tape and more. So if lead is detected, we'll make sure everyone is protected while they finish the job.

For more information, go to www.epa.gov/lead.



RED MEANS LEAD™



Detect Lead on many surfaces – instantly!



LEAD PAINT HAZARDS on:

Home exterior

- wood
- bricks
- stucco
- cement
- metal
- window frames
- shutters
- doors
- door frames
- stair railings

Home interior

- walls, especially the bathroom and kitchen
- kitchen cupboards
- floors
- stairs
- handrails
- moldings

OTHER LEAD HAZARDS:

Dust

- threshold
- under deteriorating paint
- fabric, carpeting

Polyvinyl plastics

- mini blinds
- electrical cords

Porcelain enameled fixtures

- bathtubs
- sinks
- toilets

Ceramic tile

- kitchens
- bathrooms
- hearths

Brass

- key rings
- inner fixtures on faucets
- inner fixtures on well pumps

Solder

- copper pipes leading to tap
- stained-glass windows

How to use 3M™ LeadCheck™ Swabs:

Read full instructions found in package before use.

Each 3M™ LeadCheck™ Swab contains two crushable vials, one with a lead-reactive dye, the other with a pre-measured activator solution. Crush the vials to mix the contents, then bring the tip into contact with the surface to be tested.

ACTIVATION:

one

CRUSH. Squeeze and crush points marked “A” and “B,” located on the barrel of the Swab.

two

SHAKE AND SQUEEZE. With the Swab tip facing down, shake twice and squeeze gently until the yellow liquid comes to the tip of the Swab — it’s now activated for testing.

three

RUB. While squeezing gently, rub the Swab on the test area for 30 seconds. If the tip turns red or pink, lead is present.

Each 3M™ LeadCheck™ Swab has no shelf life. EPA recognized when used by a certified renovator to determine that lead-based paint is not present on wood and metal. Plaster and drywall EPA recognition pending.

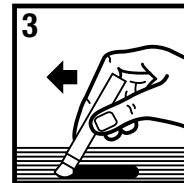
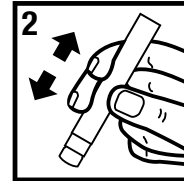
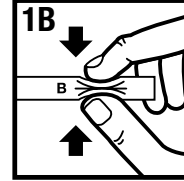
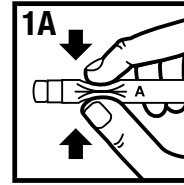

Product Ordering Information

CAT #	Description	Stock #	Billing UPC	Shipper UPC #	Case Qty.	Case Height	Case Length	Case Width	Case Weight (lbs.)	Each MSRP
LC-8S10C	8 Swab / 10 pks per case	70-0051-1933-7	17834-20910-2	17834-20910-9	10	8.313"	12.25"	4.5"	1.47	\$ 29.99
LC-2S24C	2 Swab / 24 pks per case (4 inners of 6)	70-0051-1938-6	51141-93613-0	51141-93613-5	24	9"	8.375"	4.937"	1.862	\$ 9.99
LC-2S24C-CS	2 Swab / 24 pks per case (CLIPSTRIP)	70-0051-2227-3	51141-34093-7	51141-34093-7	24	2.375"	29.25"	8.75"	1.8636	\$ 9.99
LC-8S20C	8 Swab / 20 per case	70-0051-1939-4	17834-20910-2	17834-20920-8	20	4.813"	8.25"	7.625"	2.039	\$ 29.99
LC-48SCP3C	48 Swab Contractor Pack / 3 pks per case	70-0051-1940-2	51141-93685-7	51141-93685-2	144	3.937"	11.937"	3.937"	2.41	\$ 149.99

Dependable Lead-Safe Work Products

3M

3M Center, Building 223-4S-02
St. Paul, MN 55144-1000
1-800-494-3552
www.3MLeadCheck.com

3M, LeadCheck and RED MEANS LEAD
are trademarks of 3M. © 2011 3M.

Please recycle. Printed in U.S.A.
All rights reserved. 70-0713-4032-0

